

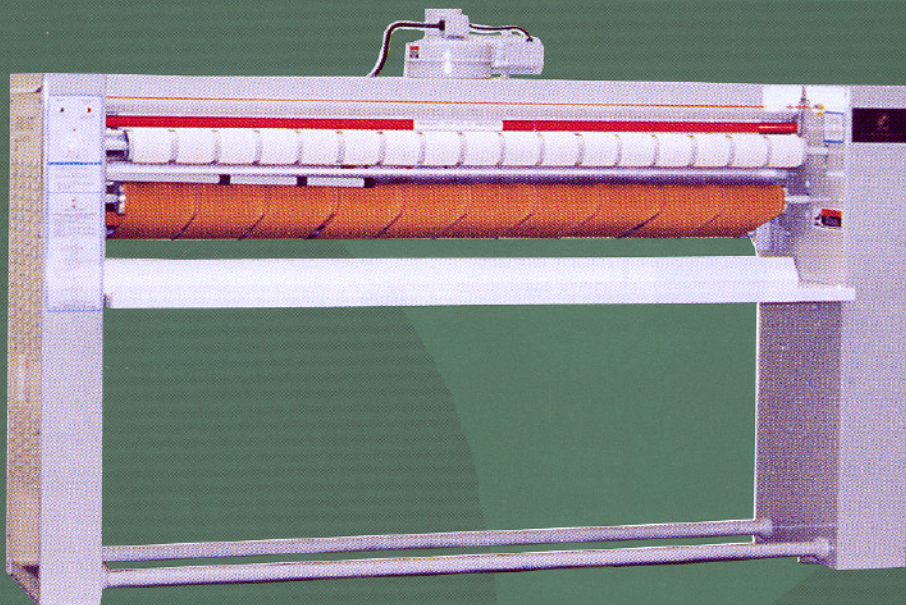

CMV SHARPER FINISH

"The Ironer People"



FINISH RITE®

"One of over 100 model ironers we manufacture."



CMV Sharper Finish

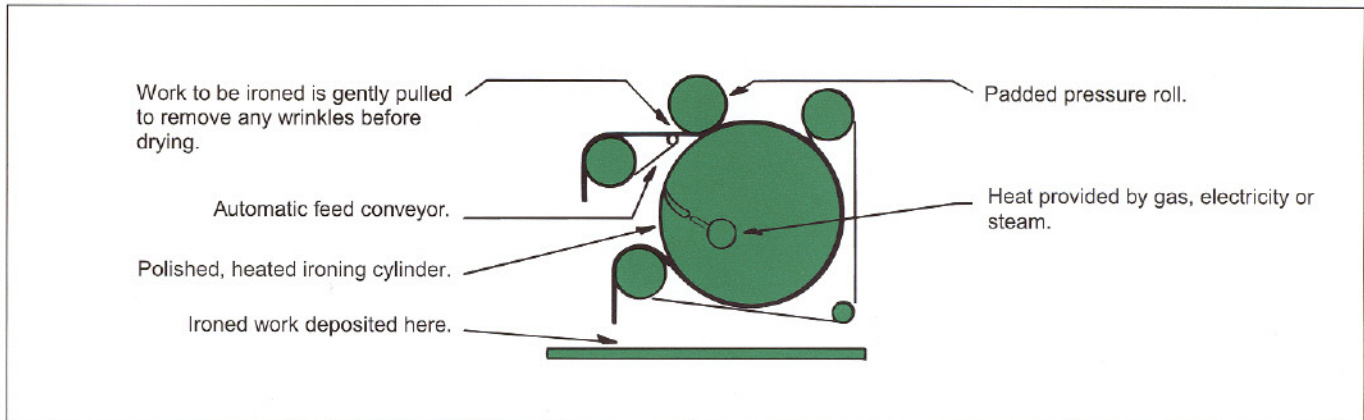

The ironing process of the Finish Rite ironer – and the results – are very similar to careful hand ironing, but considerably faster and easier. The padded pressure roll that applies just the right amount of pressure automatically to smooth out the wrinkles produces the exceptional ironing quality. The surface speed of the automatic feed conveyor is less than the pressure and heated rolls. The result is a gently pulling action that removes wrinkles before the linen is firmly held against the heated roll for drying. Linen to heated roll contact is nearly 420 square inches, offering superior drying capacity. Far more stretching and drying can be done with the Finish Rite than by comparable single roll chest ironers.

Why Iron?

Unfinished linens can destroy the ambiance of an otherwise well appointed dining or hotel room. “No-Iron” linens were developed primarily for home use, where dryer temperatures and spin cycles can be precisely set and the flatwork can be taken from the dryer in time to preserve an acceptable appearance. This degree of personal attention is not possible, even in the smallest of commercial laundry operations.

An on-premises laundry provides a significant dollar savings and is considerably more convenient and flexible than an outside service.

Simplified Operation

The Finish Rite greatly simplifies ironing. An operator can be trained to use the Finish Rite in a short period of time.

Linen to be ironed is taken from the washer/extractor and placed on the Finish Rite’s automatic feed conveyor, which guides the linen accurately and at the correct speed to a highly polished, heated finishing roll (excessive moisture might require the linen to be placed in a dryer for a short time prior to ironing).

After passing over the heated roll, the ironed linen is deposited on a table conveniently located at the front of the machine. The linen can now be stacked or folded for immediate use.

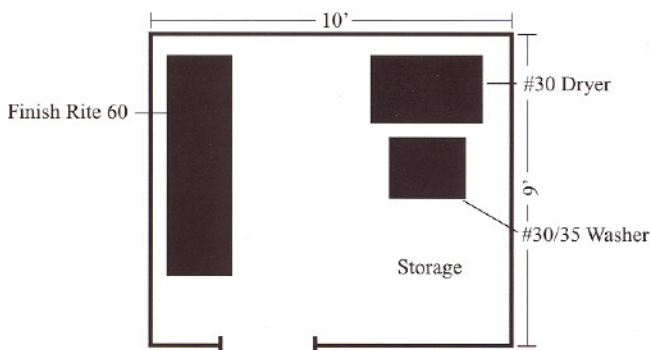

Now for the first time ever, you can have a complete professional on premise laundry in less than 100 square feet. This laundry will be capable of producing low cost, high quality work such as tablecloths, napkins, uniforms and a host of their launderable items.

Check the layout above and you will see that in an area of 9' x 10' (90 square feet) a complete laundry can be installed. This layout can produce over 200 – 54" tablecloths plus over 800 – 20" napkins and over 50 pounds of miscellaneous items per 8-hour day with only one operator.

Of course, many other layouts can be made to best suit your exact requirements.

Guidelines To Finish Rite Capacity

Estimated Hourly Production*

Item	Model 48	Model 60
Napkin	400	500
Place Mat	300	400
Tablecloth (54x54)	40	80
Pillow Case	250	250
Sheet	30 (twin)	30

*In preparing the above guideline, it was necessary to assume certain conditions such as:

- 1) All blended 50/50 materials are to be processed.
- 2) Moisture content of processed items will not exceed 20% of their weight.

The maximum theoretical productive capacity of each of the above models greatly exceeds the estimated hourly production shown. The estimated hourly production figures we have shown are realistic and attainable.

Production may vary widely from one installation to another and is dependent on many factors such as, but not limited to, degree of moisture remaining in items to be ironed, type of material, quality requirements, preparation before ironing, ambient temperature, relative humidity and skill of operator.

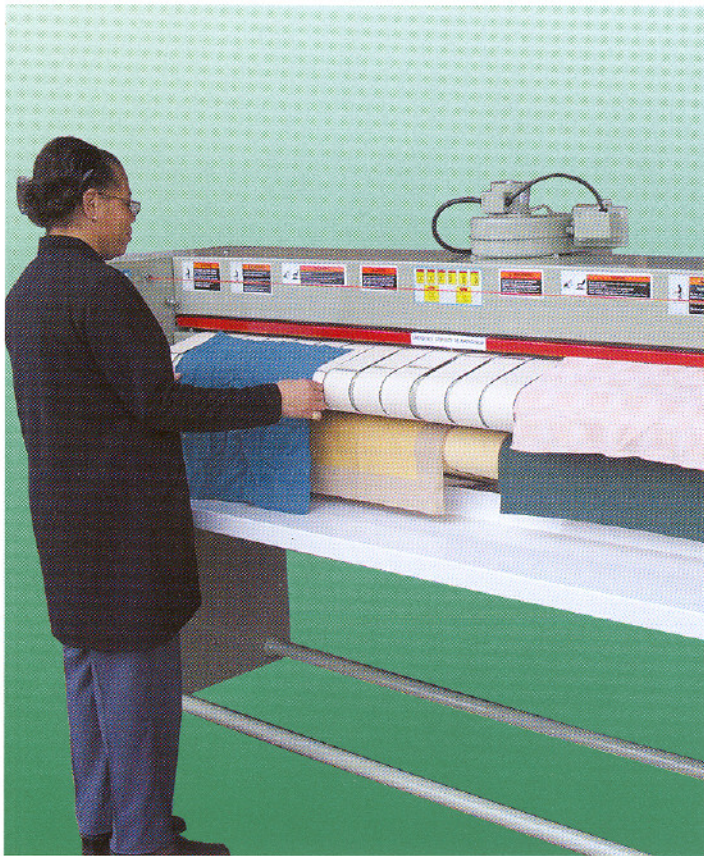

Intelatrol Automatic Monitoring System

We all need to be reminded of things from time to time. Have you ever forgotten to lock a door or turn off a light? Well, your laundry operator could forget to turn off the heat to your ironer, wasting energy and creating a hazard. They cannot forget if they have a Finish Rite ironer equipped with the Intelatrol.

The Intelatrol will shut off the heat after twenty minutes if the machine is left unattended. A red light will indicate that the Intelatrol deactivated the system, thus saving energy, eliminating a potential hazard, and greatly increasing the life of your ironer ribbons and padding.

When the operator returns and activates a switch to reset the Intelatrol, the heating system will be activated, and when ready to operate, a green light will indicate the Finish Rite is ready to begin ironing.

Features

- Choice of 48" (1.2m) or 60" (1.5m) ironing width. Ideal for tablecloths, napkins, or pillow cases. Sheets and other large linens can be folded once and ironed.
- Made by "The Ironer People". This is all we do and we do it well. You cannot find an ironer on the market that is less complicated than the Finish Rite. We have worked hard to simplify our design so you have less to worry about. Making the machine too complex should not complicate ironing – the Finish Rite makes it easy for you.
- The "mean-green machine". We use thick gauge metal with steel welded construction. This makes the Finish Rite stronger than any other machine in its class, insuring a long life and maximum return on your investment. The entire machine is finished with a high grade "CMV Green" colored machine enamel, or other colors if desired.
- The Finish Rite requires minimal floor space. The Finish Rite can be placed against a wall, saving space in your laundry.
- Delivers beautifully ironed linen in any material: cotton, blended polyester/cotton, or all synthetics. Delicate fabrics such as silk can also be ironed with the Finish Rite Temperature Control.
- Instructional displays are located on the machine to remind operators of proper use. Each Finish Rite is provided with instructional manuals and a video demonstrating proper installation, use, and maintenance.
- E.T.L. approved. Safety features include front, rear, and side interlocked guards; 24V controls; full width hand guard; full width on/off switch cable; properly sized exhaust blower to vent moisture and harmful products of combustion; accurate thermostatic heat control with high temperature shutoff; high gas pressure shut-off switch; and numerous warning labels and instructions.
- The Finish Rite can be heated by gas or electricity. The gas-heated models are equipped with a full width multi-port induced draft burner that evenly distributes the heat with a total of only nine parts. Compare that to other burners using nearly fifty parts or those that heats oil and have two pumps and long piping to heat the ironer.
- Quality ironing. The Finish Rite ironer uses Nomex padding and ribbons with automated pressure regulation to iron, dry, and remove wrinkles.

DIMENSIONS

*Canopy blower has 4" round (102 mm) discharge connection. Blower will discharge 160 CFM at .5" S.P.

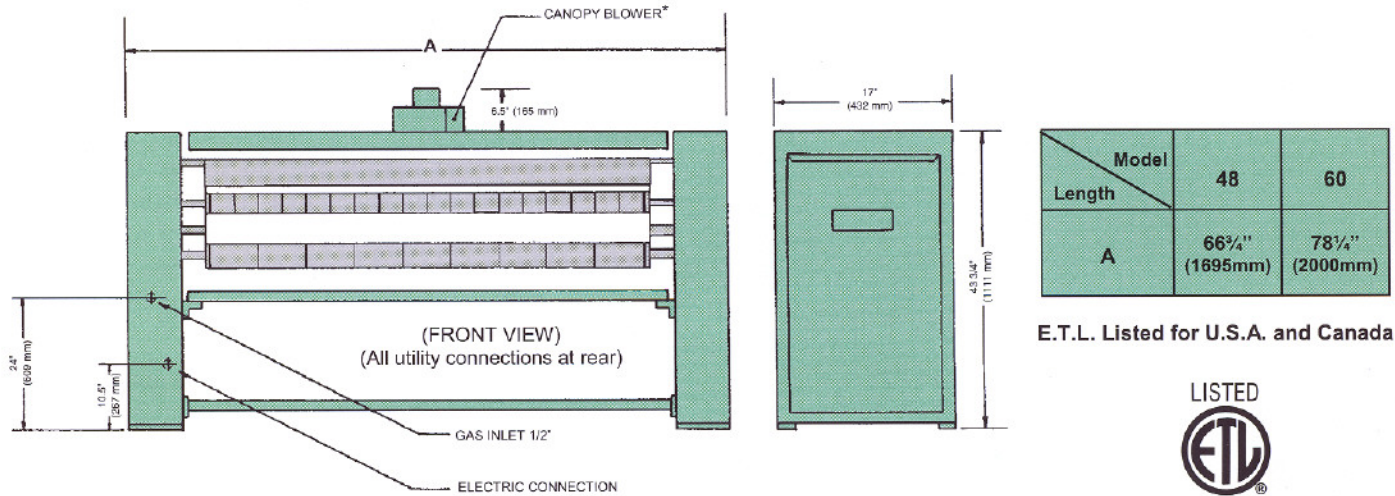

Model	48	60
Length	66 3/4" (1695mm)	78 1/4" (2000mm)
A		

E.T.L. Listed for U.S.A. and Canada



TECHNICAL DATA – FINISH RITE®

MODEL	G48 (GAS)	G60 (GAS)	E48 (ELECTRIC)	E60 (ELECTRIC)
Finishing Surface Width Inches (mm)	48 (1219)	60 (1524)	48 (1219)	60 (1524)
Heated Roll Diameter Inches (mm)	7 (178)			
Ironing Speed Feet Per Minute (m/min)	14 (4.3)			
Electrical Requirements	120/60/1	20A Standard	240/60/1	60A Standard
	(Also available in other voltages; 50 cycle; 3 phase)			
Maximum Gas Input B.T.U. / hr. (CAL. Kg/h)	24000 (6048)	30000 (7560)	—	—
Electrical Requirements – Heating KW	—	—	7.0	8.8
Net Weight Pounds (Kg)	490 (222)	553 (249)	510 (229)	570 (256)
Crated Size L x W x H Inches (mm)	75 x 29 x 58 (1905 x 724 x 1461)	87 x 29 x 58 (2210 x 724 x 1461)	75 x 29 x 58 (1905 x 724 x 1461)	87 x 29 x 58 (2210 x 724 x 1461)
Crated Weight Pounds (Kg)	550 (247)	600 (272)	570 (256)	620 (279)
Crated Volume Cubic Feet (Cubic m)	71 (2.0)	82 (2.3)	71 (2.0)	82 (2.3)



CMV Sharper Finish, Inc.

4500 Augusta Boulevard
 Chicago, Illinois 60651 U.S.A.
 Telephone: 773-276-4800
 Facsimile: 773-276-6878
 Email: sales@cmvsharperfinish.com
 www.ironerpeople.com

Distributed by:

QUESTIONS: 1-800-247-IRON

Copyright 2005 by CMV Sharper Finish, Inc. Form No. 5058R2. In view of CMV's policy of providing you with the best products possible, we reserve the right to change specifications and appearance without notice. Contact the sales department for exact specifications, dimensions, and product approvals. We make over 100 different models that are sold throughout the world.